

Exterior Plywood Wall D

Bottom Beam Rests Directly on Deck

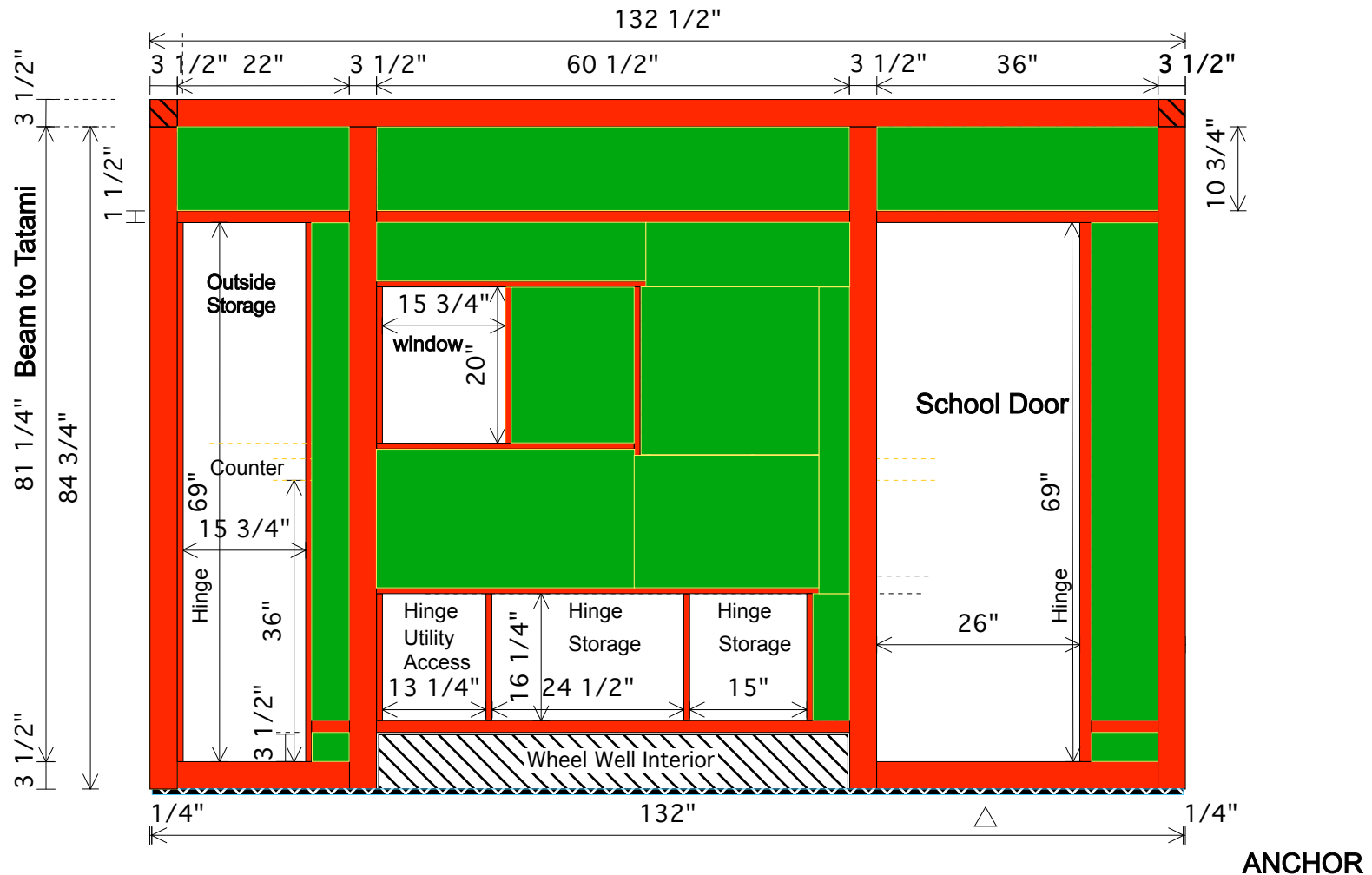

- ⓓ All 4x4 beams in the drawing project 1/4" beyond trailer bed
- ⓓ Other woodwork and plywood siding is flush with edge of trailer bed.

Use 3/4" x 5 1/2" (1 x 6) stock for the external frame for the window. This frame extends 2 1/2" beyond the interior surface of the plywood panel and 2 1/4" beyond the exterior surface of the plywood panel. Use 3/4" x 3 1/2" (1 x 4) stock for the center divider. The divider extends to the outer surface of the plywood panel. Cut 28 3/4" x 20" hole frame for the window and insert plywood plug in the right hand half.

Approved 2009/05/04
Checked 2009/05/27

On this side - The exterior plywood wall is flush for it's entire length. This is different from side B where the wall above the wheel well is inset. The exterior window for this side is flush with the inner wall.