

Framing Wall A

Bottom Beam Rests Directly on Deck

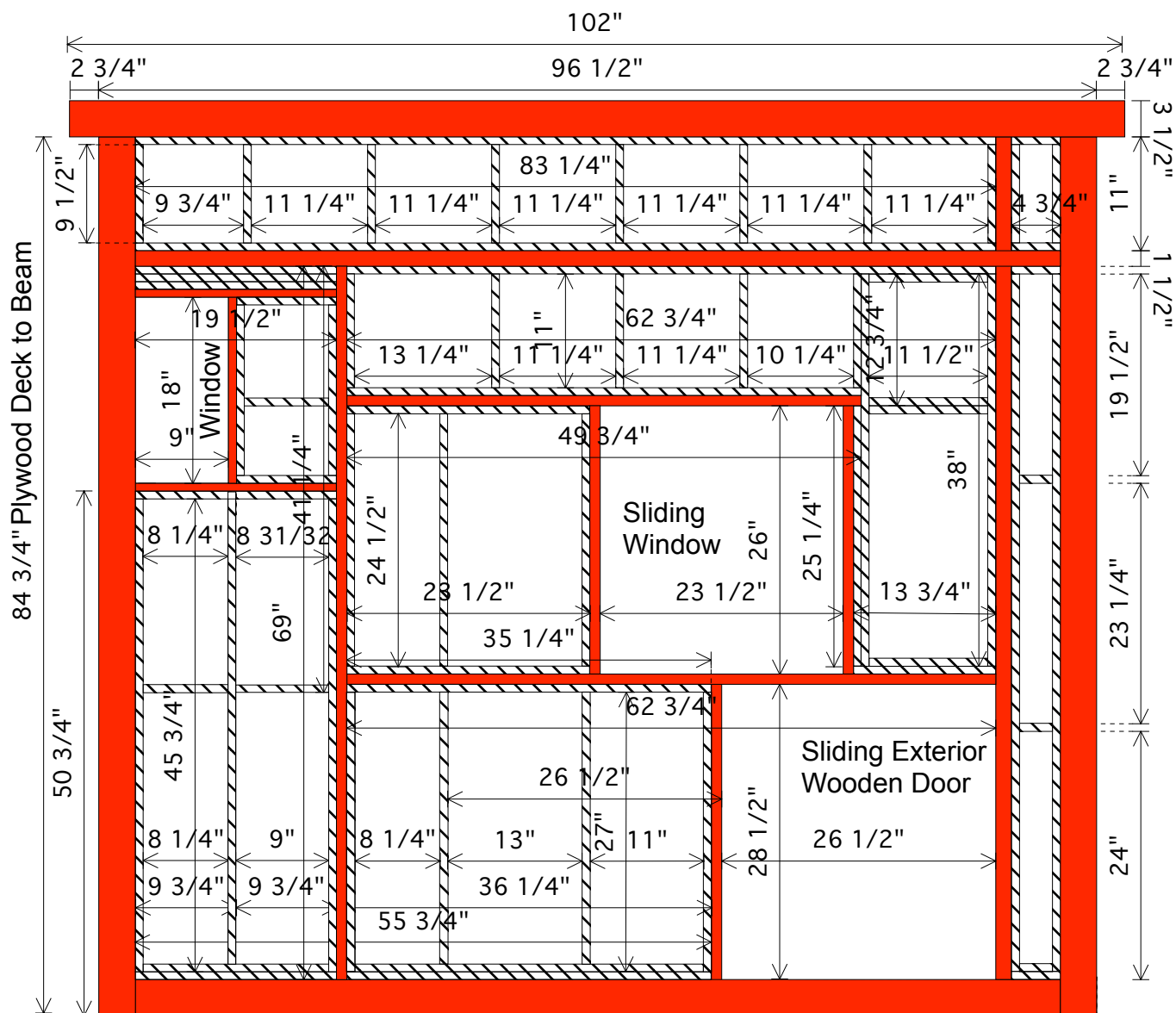

A

ANCHOR

Note: Exterior wall surface is flush with trailer bed.

Note: All 4x4 and 2x4 posts and beams in the drawing project 1/4" beyond the trailer bed.

Note: Major division into four quadrants is achieved with 1 1/2" x 3 1/2" (2x4) stock.

Note: Architectural detail is framed with 3/4" x 4 1/2" (1 x 5) stock.

Note: The framing for architectural detail for this wall is flush with the outer wall and overhangs the inner wall by 3/4". The wall is 3 3/4" thick.

Note: The dimensions of the nijiriguchi and the window above it are from the *Yuin tea room plate 51* with 1.5" added to the dimension as suggested by Negishi p. 82.

Note: Cross hatched detail framing is made with 3/4" x 2 1/2" (1" x 3") Hinoki wood and does not penetrate the inner wall. It is aligned flush with the exterior plane of the major timbers. 1/4" x 3/4" S4S molding can be substituted to avoid extra plywood cuts.

Note: Penetrating window framing will be 1" thick. See note on window framing.